

## Full Height Turnstiles

### PF4000 Full Height Double Turnstile



#### PF4000

#### Locinox Head Mechanism

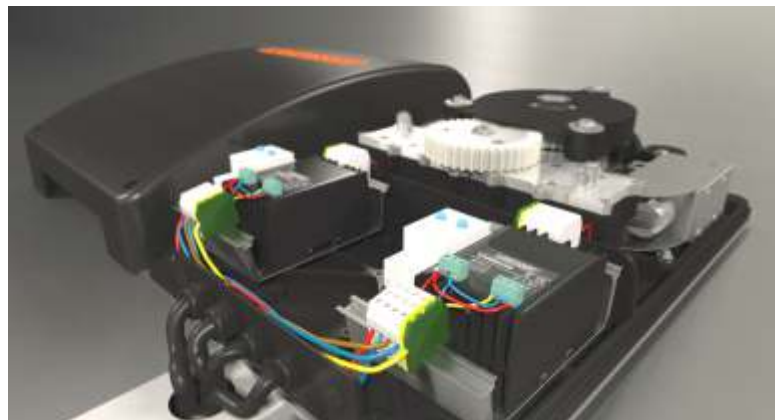
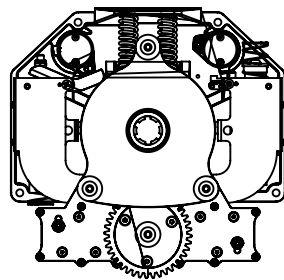
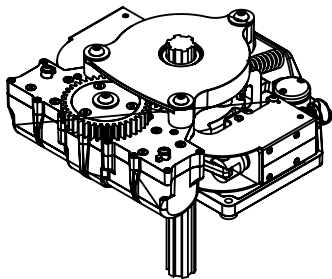

#### PF4000 Optional Extras

- LED Down Lights
- Canopy
- Directional Indicators
- Bespoke Access Control Plates
- 3/4 Height Turnstiles
- Stainless Steel Rotors
- Galvanised

#### Options for Access Control

- Keypad
- Proximity Cards
- Voice/Video Intercom Access
- Token Acceptors



O&M Manual



Drawing



Video available on website



## PF4000 Product Specification

<b>Specification</b>	CE Approved
<b>Flow Rate</b>	15 to 22 Person per Minute in Single Direction
<b>Finish</b>	Powder Coated (Galvanised Optional)
<b>Power Requirements</b>	Single Phase 240Volt 50Hz 5 Amps
<b>Duty Cycle</b>	100% Continuous Duty Rating
<b>Dimensions</b>	Double: 2580mm (2450) x 1400mm x 1790mm
<b>Sizes</b>	Rotor: 76mm Tube with Bottom Support Bearing Arms: 42mm Tube with Capped Ends Side Frames: 33mm Tube Welded to Curve Base Plate
<b>Power Fail Modes</b>	Fail Safe or Fail Secure
<b>Usage</b>	Suitable for Indoor & Outdoor Use
<b>Unit Weight</b>	450Kg Approx

