

LUX/S/B-19 AUTOMATIC RAISE ARM BARRIER
RIGHT HANDED

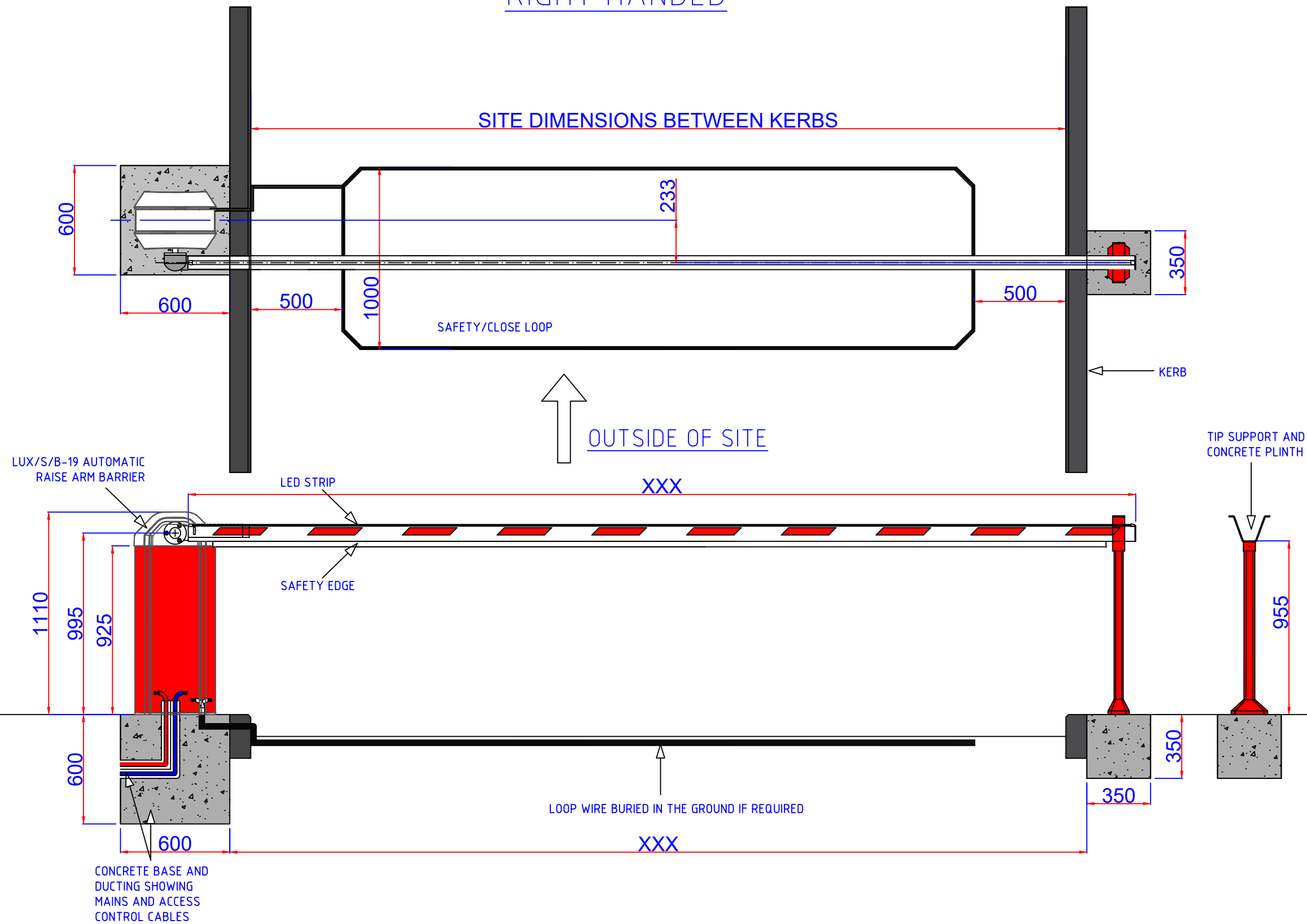

GENERAL NOTES

- 1.FOUNDATIONS MUST BE LEVEL/IN-LINE.
- 2.BARRIER MUST RUN LEVEL.
- 3.IF IN DOUBT, PLEASE ASK!

DIMENSIONS & SPECIFICATIONS

FOUNDATIONS:
RECOMMENDED CONCRETE C40 MIX

S/B/LUX: L = 600mm. H = 600mm. W = 600mm.

HEAVY DUTY: L = 700mm. H = 600mm. W = 700mm.

POWER REQUIREMENTS

240v SINGLE PHASE,
50Hz 10 Amps
or 300mA RCD Type C Breaker

BOLT INFORMATION

INCLUDED—
MAIN BARRIER:
HEAVY DUTY: M16 BOLTS
S/L/B: M12 BOLTS

OPTIONS

HI-BAR OPTION AVAILABLE (TOP & BOTTOM SKIRT) →

SKIRT OPTION AVAILABLE →

1.	Revision 01	
No.	Revision/Issue	

PF6000-19 LUX-S-B, XM RH

ORDER REFERENCE:
ORDER NUMBER:

Draw Number:	Sheet
Date:	1.